

theDelamere

Beautiful homes... delivered



4 Beds



2 Baths



164.20 m²

The Delamere provides a sophisticated and relaxing atmosphere, spacious enough for the whole family to come together. Entertaining friends is simple thanks to a convenient central family area positioned in the heart of the home, whilst a master or 'parents retreat' sits separate to the remainder of the bedroom and bathroom floor plan. Front and rear access makes this a great Australian allrounder.

Features:

- Large 4 bedroom versatile prefab modular design
- Suitable for up to 10 people (subject to bedding configuration)
- Sizable open plan living and entertaining footprint
- Galley style kitchen with walk-in pantry
- Quality Fisher & Paykel kitchen appliances
- Generous storage for extended stays
- Perfect for long-term residents or manager's residence
- Tiled bathroom floor and walls
- BlueScope Truecore® structural framework - exclusive to ASTH & MJH Group
- Year-round comfort with effective 6-star energy rated insulation
- Clear glazed aluminum windows with colour-matched fly screens
- Data connectivity including NBN provision





Facades displayed above are for illustrative purposes only and some items may not be included in the price

floorplan: Standard

4 Bedrooms

2 Bathrooms

Width : 18.00m

Length : 9.10m

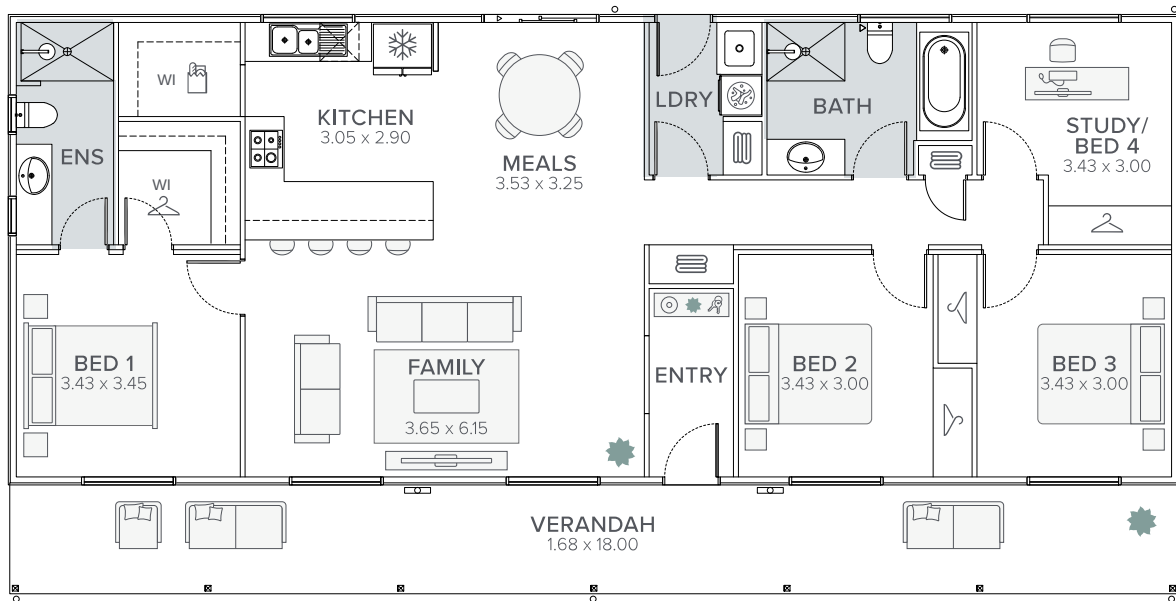

Interested in getting

Call us on: **1800 219 278**