

# theBrentwood

Beautiful homes... delivered



3 Beds



2 Baths



156.40 m<sup>2</sup>

The unique Brentwood design is perfect for a family or holiday home. Key features of this prefab house include stunning light filled living areas, a walk-in kitchen pantry, sizeable master bedroom with ensuite and walk in robe, with the ultimate open-plan entertaining area and covered verandah at the rear of the home.

## Features:

- 3 bedroom executive style park living
- Suitable for up to 6-8 people (subject to bedding configuration)
- Generous storage for extended stays
- Easy entertaining with covered rear verandah
- Comfortable, open plan living to take in the views
- Second living space for the kids to retreat
- Quality Fisher & Paykel kitchen appliances
- Tiled bathroom floor and walls
- BlueScope Truecore® structural framework - exclusive to ASTH & MJH Group
- Year-round comfort with effective 6-star energy rated insulation
- Clear glazed aluminum windows with colour-matched fly screens
- Data connectivity including NBN provision

[Click here to download the MyStyle Inclusions brochure](#)





Facades displayed above are for illustrative purposes only and some items may not be included in the price

# floorplan: Standard

3 Bedrooms

2 Bathrooms

Width : 7.24m

Length : 21.60m

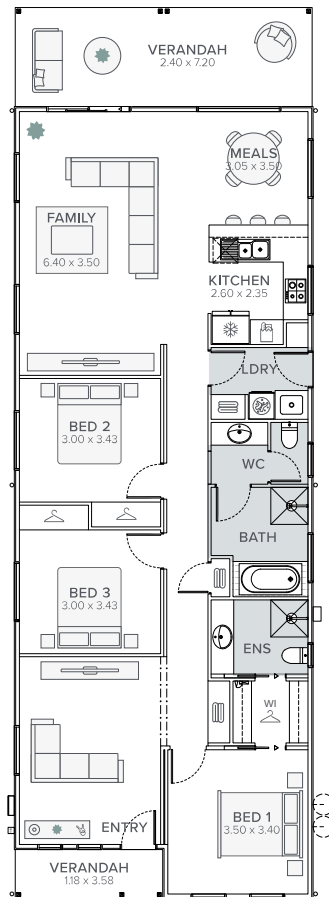

Interested in getting

Call us on: **1800 219 278**